

INDUSTRY STUDIES ASSOCIATION



2017

Industry Studies Conference



May 24-26
Washington, DC



Ewing Marion
KAUFFMAN
Foundation

SCHEDULE

for <https://www.industrystudiesconference.org/conference>



Conference in Brief

LOCATION

The conference events are held at the Washington Court Hotel.
525 New Jersey Ave NW, Washington, DC 20001 | <http://www.washingtoncourthotel.com/>

REGISTRATION

Wednesday, May 24: 4:00 p.m.—7:00 p.m., Washington Court Hotel Lobby
Thursday, May 25: 7:00 a.m.—4:00 p.m. Washington Court Hotel Lobby
Friday, May 26: 7:00 a.m.—2:00 p.m., Washington Court Hotel Lobby

WEDNESDAY MAY 24, 2017

12:00 p.m.—4:30 p.m. Excursion: “The K Street Crawl”
1:00 p.m.—6:00 p.m. Professional Development Workshop
6:30 p.m.—8:00 p.m. Welcome Reception

THURSDAY MAY 25, 2017

8:00 a.m. Welcome and Plenary I: “Low-wage, Low-quality Work on the Front Lines: Industry Determinants and Policy Prescriptions”
10:00 a.m. Concurrent Sessions 1A—1G
12:00 p.m. Business Meeting and Lunch
1:30 p.m. Concurrent Sessions 2A—2G
3:45 p.m. Concurrent Sessions 3A—3G
5:30 p.m. Sessions conclude
6:30 p.m. Industry Studies Conference Reception

FRIDAY MAY 26, 2017

8:00 a.m. Plenary II: “U.S. Industry in the World Economy: A New Era?”
10:00 a.m. Concurrent Sessions 4A—4G
11:45 a.m. Awards Luncheon
1:30 p.m. Concurrent Sessions 5A—5G
3:45 p.m. Concurrent Sessions 6A—6G
5:30 Adourn

ROOM LOCATOR MAP

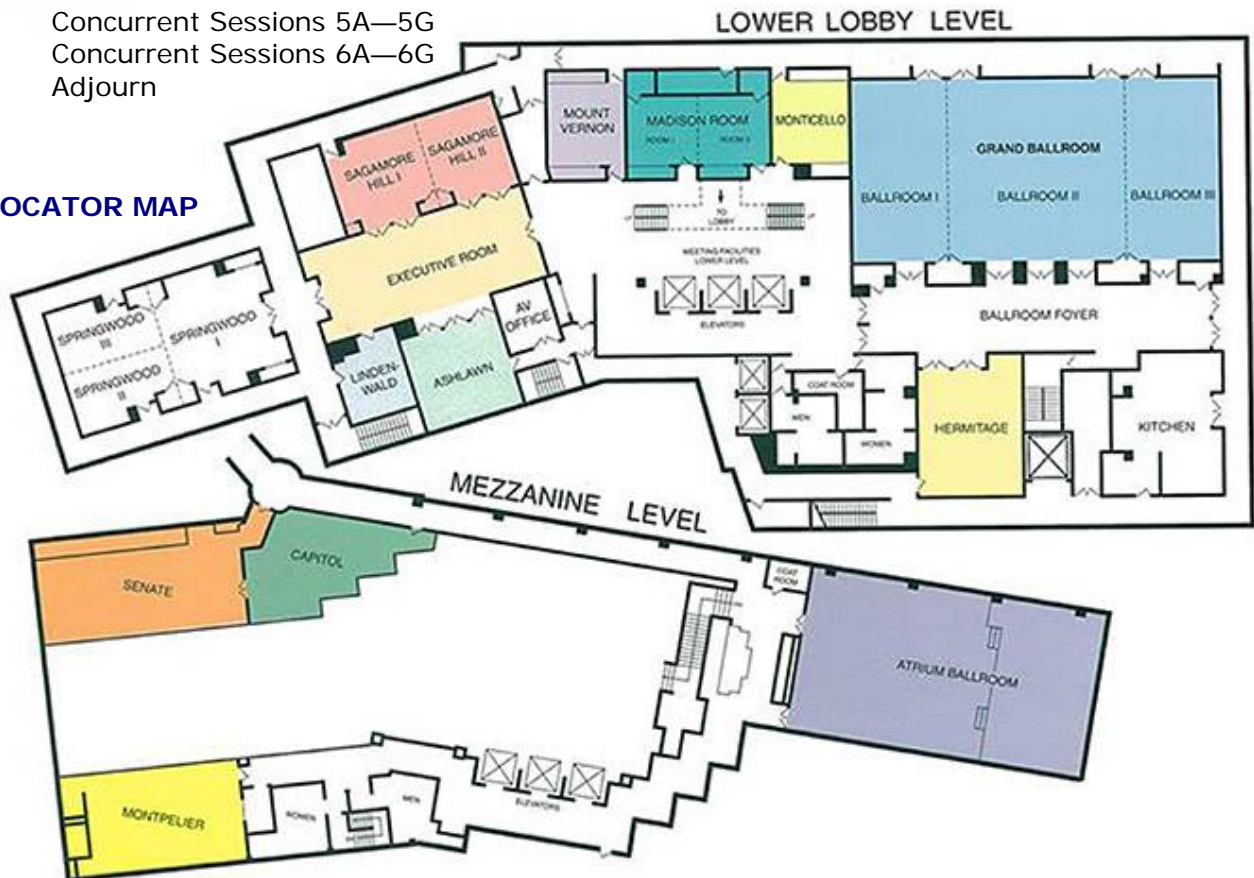

Research Stream Legend

Throughout the conference schedule, panels indicate which one of the eight ISA research streams they represent by the following abbreviations and color scheme:

1. **Energy, Power, & Sustainability (EP&S)**
2. **Healthcare (H)**
3. **Globalization: Management & Policy Implications (G:M&PI)**
4. **Innovation & Entrepreneurship (I&E)**
5. **Technology Management (TM)**
6. **Labor Markets, Organizations, & Employment Relations (LMO&ER)**
7. **Supply Networks, Operations and Engineering Management (SNO&EM)**
8. **General Industry Studies (GIS)**

Conference Program: Wednesday, May 24

EXCURSION: "THE K STREET CRAWL"

12 p.m.—4:30 p.m.

PROFESSIONAL DEVELOPMENT WORKSHOP

1:00 p.m.—2:00 p.m. Lunch Springwood Room

2:00 p.m.—6:00 p.m. Workshop Montpelier Room

ISA BOARD MEETING (for board members only)

3:00 p.m.—6:00 p.m. Mt. Vernon Room

INDUSTRY STUDIES CONFERENCE WELCOME RECEPTION

6:30 p.m.—8:00 p.m. Atrium Ballroom

Conference Program: Thursday, May 25

BREAKFAST

7:00 a.m.—8:00 a.m. Atrium Ballroom

WELCOME BY THE ISA PRESIDENT Peter Berg

PLENARY I

8:00 a.m.—9:30 a.m. Atrium Ballroom

BREAK 9:30 a.m.—10 a.m.

Thursday, May 25
8:00 a.m.-9:30 a.m.

PLENARY I: Low-wage, Low-quality Work on the Front Lines: Industry Determinants and Policy Prescriptions

Panelists' Bios

Moderator:



Ylan Q. Mui joined CNBC in February 2017 as a Washington, D.C.-based reporter focusing on economic and regulatory policy issues. Mui joined CNBC after spending nearly 15 years at the Washington Post, most recently as White House economic policy correspondent. She previously covered the Federal Reserve and the macroeconomy, subprime lending, consumer finance, retail, and education. In addition, Mui reported on major international stories, including the Greek financial crisis and Brexit, as well as national disasters such as the BP oil spill and Hurricane Katrina. She is a member of the Asian American Journalists Association, a past vice president of its Washington, DC chapter, and a graduate of its Executive Leadership Program.



Susan Helper is the Frank Tracy Carlton Professor of Economics at the Weatherhead School of Management at Case Western Reserve University. She was formerly Chief Economist at the U.S. Department of Commerce and a senior economist with the White House Council of Economic Advisers. Her research focuses on the globalization of supply chains, and on how U.S. manufacturing might be revitalized. In addition to serving as chair of her home department, Dr. Helper has been a visiting scholar at the University of Oxford, the University of California (Berkeley), Harvard University and the Massachusetts Institute of Technology. She received her Ph.D. in Economics from Harvard University.



Paul Osterman is the Nanyang Technological University (NTU) Professor of Human Resources and Management at the Sloan School of Management and a member of the Department of Urban Planning at the Massachusetts Institute of Technology. His research concerns changes in work organization within companies, career patterns and processes within firms, economic development, urban poverty, and public policy surrounding skills training and employment programs. Osterman's new book, *Who Will Care for Us: Long Term Care and The Long Term Workforce*, addresses work- and worker-related issues in the long term care sector. It lays out a strategy for improving the jobs of direct care workers and speaks to both the social policy challenge of improving America's long term care system and the labor market challenge of upgrading low wage jobs. He holds a Ph.D. in Economics and Urban Studies and Planning from M.I.T.



Dan Yager is CEO of the HR Policy Association. A nationally recognized expert on employment policy issues, he has authored several books on labor relations and teaches courses on the law of collective bargaining and labor dispute planning. In 2014, he was elected a Fellow of the National Academy of Human Resources. In addition to his work with the Association, Mr. Yager is a senior partner of McGuiness & Yager LLP, a Washington, D.C.-based law firm specializing in employment, compensation, benefits, and labor law, and general counsel to the Health Care Policy Roundtable. He received his J.D., cum laude, from the University of Santa Clara School of Law in 1975 and is a member of the D.C. and California Bars.



Thursday, May 25

PANEL SESSION ONE 10:00 a.m.—11:45 a.m.

1A Forecasting Technology and Occupational Structure (GIS)

Atrium Ballroom

Chair: **John Paul MacDuffie** (University of Pennsylvania)

False Alarmism: Technological Disruption and the U.S. Labor Market, 1850–2015, and Perspectives Looking Forward

Robert Atkinson (Information Technology and Innovation Foundation)

Writing Questions for Forecasting Tournaments: Defeating the Rigor-Relevance Tradeoff

Kathryn Cochran (Good Judgment Inc.)

Forecasting Demand for Alternative Drive Train Vehicles

David Keith (MIT)

Technology Forecasting at an Industry Inflection Point

John Paul MacDuffie (University of Pennsylvania)

Rahul Kapoor (University of Pennsylvania)

1B Measuring Industry Evolution and Change (GIS)

Executive Room

Chair: **David Hart** (George Mason University)

Overcoming the Use of Standard Industry Classification Systems: Inter-industry Interactions and Evolution of Industries

Dong Wook Huh (Frostburg State University)

Ehsan Ardjmand (Frostburg State University)

New Technology Indicator for Technological Progress

Wendy Li (U.S. Bureau of Economic Analysis)

Estimating Capital Services in the U.S.: An Empirical Assessment of Implementation Differences

Jon Samuels (U.S. Bureau of Economic Analysis)

1C Innovation and Entrepreneurship Around the Globe (I&E)

Montpelier Room

Chair: **Vivek Ghosal** (Rensselaer Polytechnic Institute)

Conditions for ICT Growth, Development, and Innovation in the Greater Toronto Area

Steven Denney (University of Toronto)

David Wolfe (University of Toronto)

Travis Southin (University of Toronto)

Firm-level Human Capital and Innovation: Evidence from China

Vivek Ghosal (Rensselaer Polytechnic Institute)

The State of Mexican Start-ups

Claudia Gonzalez-Brambila (ITAM)

Daniela Ruiz-Massieu (ITAM)

Thursday, May 25

The Impact of Information Technology on National Innovation: The Moderating Influence of National Culture

Terence Saldanha (Washington State University)
Babu John Mariadoss (Washington State University)
Michelle Wu (Washington State University)
Sunil Mithas (University of Maryland)

1D Unpacking Diversity and Leadership: Industry, Organizational and Individual Consequences (GIS)

Senate Room

Chair: **John McCarthy** (Cornell University)

Diversity and Inclusion in the U.S. Graphic Communication Industry
Twyla Cummings (Rochester Institute of Technology)

Top management team tenure, competitive repertoires, and firm performance in the 3D printing industry
Brian Fox (University of Connecticut)

Using Diversity Intelligence for Human Capital Effectiveness
Claretha Hughes (University of Arkansas, Fayetteville)

Intergenerational Leadership: Coordinating Common Goods and Economic Stability
Julia Ptaschunder (The New School)

How Important are Parental Occupations to the New Generation's Occupational Mobility?
Frank Stafford (Department of Economics University of Michigan Ann Arbor 48109)
Ping Li (Economics and Management College South China Normal University)

1E Technology Management (TM)

Ashlawn Room

Chair: **Hila Lifshitz-Assaf** (New York University)

Understanding the Disconnect Between Perceived and Actual Burden of Government Oversight
Samantha Brainard (George Washington University)
Zoe Szajnfarder (George Washington University)

Geographical Proximity and Inter-firm R&D Networks in the Taiwanese Biotechnology Sector
Shih-Hsin Chen (National Chiao Tung University)
Wei-Ting Lin (National Chiao Tung University)
DuenKai Chen (Tamkang University)

Revisiting the Domain Expertise Assumption for Innovation: Breaking and Reconfiguring The Boundaries Between Domain Experts and Crowds
Hila Lifshitz-Assaf (New York University)
Zoe Szajnfarder (George Washington University)

Risky Micrometeoroid and Orbital Debris(MMOD) Decision-Making at NASA: A Fuzzy-Trace Theory Approach
Deniz Marti (The George Washington University)
David Broniatowski (The George Washington University)

Cultural Capital, and the Emergence of New Market Categories in Stigmatized Industries: The Case of E-Cigarettes
Thinley Tharchen (Pennsylvania State University)
Raghu Garud (Pennsylvania State University)



Thursday, May 25

1F Buyer-Supplier Relationships and Firm Performance (SNO&EM)

Sagamore Hill 1

Chair: **Merieke Stevens** (Erasmus University)

Empirical Analysis of Supply Network Relationship Concentration, Structure, and Firm Performance in the Electronics Industry

Marcus Bellamy (Boston University)

Soumen Ghosh (Georgia Institute of Technology)

Manpreet Hora (Georgia Institute of Technology)

Investment in Collective Reputation: Produce Grower Associations and Food Safety

Erik Lichtenberg (University of Maryland, College Park)

Aaron Adalja (University of Maryland, College Park)

Elina Page (Economic Research Service, U.S. Department of Agriculture)

Temporary De-Embedding Buyer-Supplier Relationships: A Complexity Perspective

Runner-up, Giarratani Rising Star Award

Merieke Stevens (Erasmus University)

Fabian Sting (University of Cologne)

Murat Tarakci (Erasmus University)

1G Examining Healthcare Provider Performance (H)

Sagamore Hill 2

Chair: **James Ostler** (University of Michigan)

Employee Engagement and Organizational Performance

Verneda Bachus (Friend Family Health Center)

Lihua Dishman (A. T. Still University)

Integrating Post-Acute Care: Progress of Relational Contracting between Accountable Care Organizations and Post-Acute Providers

Christine Bishop (Brandeis University)

Jennifer Hefele (University of Massachusetts at Boston)

Patient Experience Impacts Financial Performance of United States For-Profit, Non-Profit, and Governmental Hospitals Differently: Evidence from a Longitudinal National Study

Lihua Dishman (A. T. Still University of Health Sciences)

The Impact of Organizational Change on Firm Efficiency: Evidence from the Healthcare Sector

Renata Kosova (Imperial College London)

Marisa Miraldo (Imperial College London)

Giorgia Marini (University of Rome)

Mujaheed Shaikh (Vienna University)

Value Capture and Strategic Misrepresentation of Information in Nonprofit, For-Profit, and Public Organizations

James Ostler (University of Michigan)

Vanessa Burbano (Columbia University)

BUSINESS MEETING AND LUNCH

12:00 p.m.-1:30 p.m.

Atrium Ballroom

Thursday, May 25

PANEL SESSION TWO 1:30 p.m.—3:15 p.m.

2A Skill Demands and Job Requirements in Evolving Industries (G:M&PI)

Springwood Room

Chair: **Adam Seth Litwin** (Cornell University)

Workforce Training Solutions: Interdependencies in the Automotive Value Chain
Allison Forbes (University of North Carolina at Chapel Hill)

The People Behind the Robots: Assessing the Labor Market of the U.S. Industrial Robotics Industry
Nancey Green Leigh (Georgia Institute of Technology)
Benjamin Kraft (Georgia Institute of Technology)

Job Requirements in the Trucking Industry
Kristen Monaco (US Bureau of Labor Statistics)
Maury Gittleman (US Bureau of Labor Statistics)

The Labor Market Impacts of Autonomous Vehicles
Regina Powers (Office of the Chief Economist, U.S. Dept. of Commerce)
David Beede (Office of the Chief Economist, U.S. Dept. of Commerce)
Cassandra Ingram (Office of the Chief Economist, U.S. Dept. of Commerce)

Is There a Skill Gap for Entry-Level IT Positions? Evidence from a National IT Helpdesk Survey
Andrew Weaver (University of Illinois at Urbana-Champaign)

2B Platforms and the Sharing Economy (GIS)

Executive Room

Chair: **Jane Davies** (University of Cambridge)

Policy, Strategy, and the Emergence of Electric Car Sharing in China
John Helveston (Boston University)

Cloud Computing Governance and its Effects on Firm Value
Mina Jafarijoo (Washington State University)
K.D. Joshi (Washington State University)

Winner Takes All: Bidding and Contesting for Highly Skilled Work on Internet Platforms
Pamela Meil (Institute for Social Science Research, Munich)

Product Decisions by Sellers on a Platform: Publishers' e-Book Offerings on Amazon Kindle
Richard Wang (Babson College)
Cameron Miller (University of Minnesota, Syracuse University)

2C Entrepreneurship and Ecosystem Development (I&E)

Montpelier Room

Chair: **David Hart** (George Mason University)

Cybersecurity in the Washington D.C. Metropolitan Area: An Industry Assessment of Regional Focus
Erran Carmel (American University)



Thursday, May 25

How Firms Navigate Cooperation and Competition in Nascent Ecosystems

Douglas Hannah (University of Texas at Austin)

Kathleen Eisenhardt (Stanford University)

When Do Users Start Their Own Businesses? Entrepreneurial Career Transitions in the Knit Design Industry

Hyejun Kim (Massachusetts Institute of Technology)

Blood Isn't Thicker than Water: The Limits of Ethnic Entrepreneurship

Michael Murphree (University of South Carolina)

2D Measuring Globalization and Intangibles (LMO&ER)

Senate Room

Chair: **Susan Helper** (Case Western Reserve University)

Extended Supply-Use Tables in Basic Prices with Firm Heterogeneity for the United States: A Proof of Concept

James J. Fetzer (U.S. Bureau of Economic Analysis)

Thomas F. Howells (U.S. Bureau of Economic Analysis)

Lin Z. Jones (U.S. Bureau of Economic Analysis)

Erich H. Strassner (U.S. Bureau of Economic Analysis)

Zhi Wang (George Mason University)

Hybrid Sourcing and Firm Organization: Studying the Production Network of the U.S. Auto Industry

Susan Helper (Case Western Reserve University)

Abdul Munasib (U.S. Bureau of Economic Analysis)

Offshoring and U.S. Innovation Capacity

Wendy Li (U.S. Bureau of Economic Analysis)

Characteristics of Special Purpose Entities in Measures of U.S. Direct Investment Abroad

Dylan G. Rassier (U.S. Bureau of Economic Analysis)

Intangibles and the Gap between Export and Domestic Prices: Implications for Measures of Growth and Productivity

Jon Samuels (U.S. Bureau of Economic Analysis)

Rachel Soloveichik (U.S. Bureau of Economic Analysis)

2E Technology Management: Reconfiguring, Platforms and Interdependence (TM)

Ashlawn Room

Chair: **Ekundayo Shittu** (George Washington University)

Equilateral Governance in Multi-sided Platforms

Juri Mattila (The Research Institute of the Finnish Economy, and Aalto University)

Timo Seppala (The Research Institute of the Finnish Economy, and Aalto University)

Genesis of Pre-Commercialization Innovation Ecosystem: Knowledge Recombination in the Pre-Commercialization Phase of Charge-Coupled Device Image Sensors-- 1969-1994

Raja Roy (Northeastern Illinois University)

Attributes that Disentangle Technology Management from Financial Portfolios

Ekundayo Shittu (George Washington University)

Zoe Szajnfarber (George Washington University)

Thursday, May 25

Technology Matching in Determining Participation in Technology Tournaments

Ademir Vroljik (The George Washington University)

Zoe Szajnarfarber (George Washington University)

2F Governance in Supply Chain Relationships (SNO&EM)

Sagamore Hill 1

Chair: **Benn Lawson** (University of Cambridge)

Market Position and Resources: A Matching Model of How Governance Choice Affects Performance

Darcy Fudge Kamal (Chapman University)

Peng Wang (University of Arizona)

Madhu Viswanathan (University of Arizona)

Scheduling Public Requests for Proposals

Janne Kettunen (The George Washington University)

Young Kwak (The George Washington University)

Pricing Business Relationships: An Experimental Investigation of Payments for Quality

Cristina Nistor (Chapman University)

Taylan Yalcin (Chapman University)

Andrew Smyth (Marquette University)

Price Adjustment Costs: Implications for Strategic Pricing Capability in Vertical Channels

Sourav Ray (McMaster University)

Mark Bergen (University of Minnesota)

Strategic Decision-Making Processes in a Global Services Industry

Padraic Regan (Trinity Business School, Trinity College Dublin, Ireland)

2G Technology in Healthcare (H)

Sagamore Hill 2

Chair: **Sara Parker Lue** (Rutgers University)

Workforce Factors and Affiliate Networks: Going Beyond Meaningful Use of Health Information Technology

Christina Frye (University of Illinois at Urbana-Champaign)

Wonjoon Chung (University of Illinois at Urbana-Champaign)

Ariel Avgar (Cornell University)

Edmund Becker (Emory University)

Machine Learning for Text Classification and the Need for Interpretation Research: A Case Study at the FDA

Keith Walker (George Washington University)

David Broniatowski (George Washington University)

Electronic Health Records and Stroke Patients' Experience: A Case Study of an Award-winning Mid-western Acute Care Hospital

Jennifer Wilbers (A.T. Still University)

Lihua Dishman (A.T. Still University)

BREAK 3:15 p.m.—3:45 p.m.



PANEL SESSION THREE 3:45 p.m.—5:30 p.m.

3A Roundtable: Next Generation Apprenticeship: Opportunities and Challenges for Expansion and Inclusion (GIS)

Springwood Room

Chair: **Susan Helper** (Case Western Reserve University)

Chair: **Nichola Lowe** (University of North Carolina, Chapel Hill)

Participants:

Dale Belman (Michigan State University)

Allison Forbes (University of North Carolina, Chapel Hill)

David Langdon (U.S. Department of Commerce)

Demetra Nightingale (Urban Institute)

3B Roundtable: Revisiting The “Expertise Is Needed” Assumption for Scientific and Technological Innovation (TM)

Executive Room

Chair: **Hila Lifshitz-Assaf** (New York University)

Chair: **Zoe Szajnfarber** (George Washington University)

Participants:

Amy Cox (AFIT)

Amy Kaminski (NASA)

Ademir Vrolijk (George Washington University)

3C Focus on Entrepreneurial Firms (I&E)

Montpelier Room

Chair: **Jennifer Woolley** (Santa Clara University)

Entrepreneurship Along the Industry Life Cycle. Does Ownership Matter?

Marco Cucculelli (Universita Politecnica delle Marche)

Valentina Peruzzi (Universita Politecnica delle Marche)

Chasing Entrepreneurial Firms

Elsie Echeverri-Carroll (University of Texas at Austin)

Maryann Feldman (University of North Carolina at Chapel Hill)

Gross Domestic Product for Small Business

Tina Highfill (U.S. Bureau of Economic Analysis)

Erich Strassner (U.S. Bureau of Economic Analysis)

The Backgrounds of Women Founders of STEM Firms: Success Factors

Jennifer Woolley (Santa Clara University)

Thursday, May 25

3D Continuing Evolution of the Global Automotive Industry (LMO&ER)

Senate Room

Chair: **Jane Davies** (University of Cambridge)

Diversifying the Southern Ontario Automotive Cluster: Establishing linkages Between the ICT and Automotive Knowledge Bases

Elena Goracinova (University of Toronto)

David Wolfe (University of Toronto)

Issues for Satisfying both Employees and Customers: A Comparative Case Study at the Branches of a Japanese Automobile Dealer

Sekai Kida (Yokohama National University)

Comparison Between Transaction of Steel for Automobiles in the US and in Japan

Yongdo Kim (Hosei University)

Structural Estimates of Depreciation: Obsolescence, Depreciation-Net-of-Obsolescence, Individual Efficiency-Loss, Own Rates of Return, and Service-Life Densities Inferred from a Rich Sample of Used-Asset Resales: '95-'05 Model-Year Ford Windstar Vans

Brian Sliker (U.S. Bureau of Economic Analysis)

3E Aligning Industrial and Innovation Policy in Emerging Economies: The Case of Brazil (I&E)

Ashlawn Room

Chair: **Elisabeth Reynolds** (MIT)

Innovation Policies in Brazil: Lessons Learned

Fernanda de Negri (Institute of Applied Economic Research, Brazil)

More Than Just Oil Rents: Brazil's Industrial and Innovation Policy in O&G

Renato Lima de Oliveira (MIT)

A New Innovation Policy Agenda for Brazil: Principles and Priorities

Elisabeth Reynolds (MIT)

Discussant: **Monica Baumgarten** (Peterson Institute for International Economics)

3F Roundtable: Sustainable Supply Chains in a Digital Interconnected World (SNO&EM)

Sagamore Hill 1

Chair: **Ram Ganeshan** (College of William and Mary)

Chair: **Tonya Boone** (College of William and Mary)

Participants: **TBA**

3G Patient and Staff Experience in Healthcare (H)

Sagamore Hill 2

Chair: **Chon Abraham** (College of William and Mary)

Knowing Your Audience: The Presence of Other Physicians and the Efficacy of Disclosure

Sara Parker Lue (Rutgers University)

Doctor, Leader, or Both? The Differential Effects of Multiple Identities on Leader Emergence

Elizabeth McClean (University of Arizona)

Tomas Martinez (University of Arizona)



Thursday, May 25

Who Gets Good Care? Bias and Resource Based Perspectives of Quality of Care in Hospitals

Chester Spell (Rutgers University)

Alok Baveja (Rutgers University)

Katerina Bezrukova (University at Buffalo)

Huiru Yang (Santa Clara University)

Abate Mammo (New Jersey Department of Health)

Sayan Mukherjee (Rutgers University)

Creating a Climate for Change: A Case Study of Worker Voice in Medical-Surgical Units

Phela Townsend (Rutgers University)

Adam Seth Litwin (Cornell University)

Sessions conclude at 5:30 p.m.

INDUSTRY STUDIES CONFERENCE RECEPTION

6:30 p.m.—8:00 p.m.

Atrium Ballroom

Friday, May 26

BREAKFAST

7:00 a.m.—8:00 a.m.

Atrium Ballroom

PLENARY II

8:00 a.m.—9:30 a.m.

Atrium Ballroom

BREAK 9:30 a.m.—10 a.m.

Friday, May 26
8:00 a.m.-9:30 a.m.

PLENARY II: U.S. Industry in the World Economy: A New Era?

Panelists' Bios

Moderator:



Steven Pearlstein, an award-winning business and economics columnist for the Washington Post, serves as Robinson Professor of Public Affairs at George Mason University, where he helped launch the interdisciplinary Politics, Philosophy and Economics concentration. Professor Pearlstein has written for newspapers, magazines, and broadcast media during his journalistic career and worked on Capitol Hill as well. He joined the *Washington Post* as deputy business editor in 1988 and became an opinion columnist in 2003. In 2008, Professor Pearlstein was awarded the Pulitzer Prize for commentary for columns the previous year anticipating and explaining the recent financial crisis and global economic downturn. In 2011 he won the Gerald R. Loeb Award for lifetime achievement in business and financial journalism.



Ralph Gomory conducts research on the complexities of the globalized economy and the differing goals of countries and companies. He is the co-author (with William Baumol) of *Global Trade and Conflicting National Interests* (2001). Gomory served as president of the Alfred P. Sloan Foundation from 1989 to 2007, where he was instrumental in launching the Sloan industry studies centers program, the precursor to today's Industry Studies Association. Under his leadership, the Foundation also supported pioneering work on on-line learning, underrepresented minorities in STEM fields, bioterrorism, and a wide range of other issues, while expanding its role as a major funder of basic science in such fields as astronomy and marine biology. Before coming to Sloan, Gomory was Senior Vice President for Science and Technology at IBM, a firm that he had joined in 1959.



Jason Miller joined the Greater Washington Partnership as its first CEO on April 1, 2017. The Partnership is a team of civic-minded regional leaders committed to making the Greater Washington region – from Baltimore to Richmond – one of the world's best places to live, work and build a business. Before joining the Partnership, Miller served as Deputy Director of the White House National Economic Council, where he coordinated the Obama Administration's policies on manufacturing and innovation, transportation and infrastructure, taxation, energy, and entrepreneurship. His accomplishments in this role included launching the Manufacturing USA network of public-private innovation institutes and SelectUSA, the first federal effort to bring foreign direct investment to the United States. He also led White House efforts to create a path to recovery for Puerto Rico. Before his White House service, Miller worked as a management consultant, advising leading global companies on strategic and operational issues.

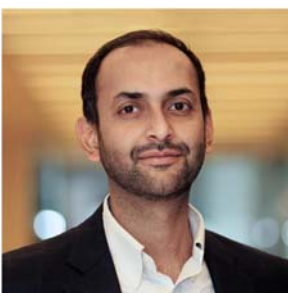

Sree Ramaswamy is a Partner at the McKinsey Global Institute (MGI), McKinsey & Company's business and economics research arm. He leads research on the economics of digitization and on trends in competition, technology, and global forces influencing multinationals. Sree is also a co-leader of MGI's research on North America, and has authored reports and articles on the ongoing digital transformation of the US economy, on new investment opportunities, on opportunities and challenges for the NAFTA region, and the role of US multinational firms in the global economy. Prior to joining McKinsey, Sree worked in regulatory affairs and engineering research for broadband satellite networks. He holds three patents.



PANEL SESSION FOUR 10:00 a.m.—11:45 a.m.

4A The Financialization of the US Industrial Corporation (GIS)

Springwood Room

Chair: **William Lazonick** (University of Massachusetts Lowell)

Stock-Based Executive Pay and the Misallocation of Corporate Resources

Matt Hopkins (The Academic-Industry Research Network)

William Lazonick (University of Massachusetts Lowell)

SEC Rule 10b-18: A License to Loot the US Industrial Corporation

Ken Jacobson (The Academic-Industry Research Network)

William Lazonick (University of Massachusetts Lowell)

US Pharma's Broken Business Model

William Lazonick (University of Massachusetts Lowell)

Matt Hopkins (The Academic-Industry Research Network)

Ken Jacobson (The Academic-Industry Research Network)

Mustafa Erdem Sakinç (The Academic-Industry Research Network)

Öner Tulum (University of Ljubljana)

Predatory Value Extraction: The Subversion of Managerial Capitalism and the Rise of Shareholder Activism

Jang-Sup Shin (National University of Singapore)

Matt Hopkins (The Academic-Industry Research Network)

William Lazonick (University of Massachusetts Lowell)

4B Regional Industrial Clusters (I&E)

Executive Room

Chair: **Jovan Grahovac** (Purdue University)

Entrepreneurial Clusters and the Co-agglomeration of Related Industries

Runner-up, Conference Best Paper in the Innovation and Entrepreneurship Research Stream Award

Carla Costa (Utrecht University)

The Co-location of Innovation and Production in Regional Clusters

Mercedes Delgado (MIT Sloan)

Agglomeration Economies in Industrial Districts: Market Evolution or Institutional Revolution?

Peter Doeringer (Boston University)

Industrial Clusters: Underlying Drivers and Implications for Firm Performance

Jovan Grahovac (Purdue University)

John Butler (University of Texas at Austin)

Friday, May 26

4C Competing and/or Partnering for Innovation (I&E)

Montpelier Room

Chair: **Mahka Moeen** (University of North Carolina)

Managing Revolutionary Inter-organizational Interdisciplinary R&D Project Teams: The Implications of Knowledge Meshing Capabilities

Melissa Appleyard (Portland State University)

Beverly Tyler (North Carolina State University)

Patents, Institutions, and Cumulative Innovation: Evidence from the Patent Depository Library Program

Jeff Furman (Boston University)

Doing It Right Time After Time: The Relationship Between Consistency and Quality

Nadav Goldschmidt (Center for Academic Studies)

An Inter-personal Approach to Early Supplier Integration in Complex NPD

Alan O'Sullivan (University of Ottawa)

Demand-side Effects on Technology Adoption: The Case of Distributed Solar Energy

Carmen Weigelt (Tulane University)

Shaohua Lu (Tulane University)

4D Exploring Employee Behaviors and Perceptions: The Roles of the Environment, Organizational Factors, and Individual Differences (LMO&ER)

Senate Room

Chair: **Christine Bishop** (Brandeis University)

At the Intersection of Agriculture, Technology, and Ethics

Velma Lee (Palm beach Atlantic University)

The Interactive Effects of Empowerment and Student Poverty on Educator Turnover

John McCarthy (Cornell University)

Flexibility or Insecurity? Managing Precariousness in a Virtual Call Center

Valery Yakubovich (ESSEC Business School)

Roman Galperin (John Hopkins University)

Mouna El Mansouri (ESSEC Business School)

4E Strategy and Policy Shaping Growth and Innovation (G:M&PI)

Ashlawn Room

Chair: **Romel Mostafa** (Ivey Business School)

Measures of International Manufacturing and Trade of Clean energy Technologies

Jill Engel-Cox (Clean Energy Manufacturing Analysis Center, National Renewable Energy Laboratory)

Qualitative Explanations for Firm Survival and Death: Evidence from the Finnish Paper and Pulp Industry 1842-2016

Juha-Antti Lamberg (University of Jyväskylä)

Mirva Peltoniemi (University of Jyväskylä)



Where are the Locals?

Osmel Manzano (Inter-American Development Bank)

Leonardo Maldonado (Inter-American Development Bank)

Pre-entry Experience, Market Adaptation & Internationalization in Mobile Telecommunications Across Africa

Romel Mostafa (Ivey Business School)

4F Developments in Manufacturing and Regional Industry (G:M&PI)

Sagamore Hill 1

Chair: **Jane Davies** (University of Cambridge)

Rural Manufacturing in the Manufacturing Extension Partnership (MEP)

Stephen Campbell (National Institute of Standards and Technology)

Kenneth Voytek (National Institute of Standards and Technology)

Nico Thomas (National Institute of Standards and Technology)

Land-Based Industries and Clusters: Capital Optionality and Diversification

Rocki-Lee DeWitt (University of Vermont)

The Internet of Things and Printed Electronics: Case Studies of Innovation by SME Manufacturers

Travis Southin (University of Toronto)

Peter Warrian (University of Toronto)

Cost-effectiveness of Rural Public Transit

Aselia Urmanbetova (Georgia Institute of Technology)

Pat McCarthy (Georgia Institute of Technology)

Laurie Garrow (Georgia Institute of Technology)

4G Technology Adoption, Behavioral Change, and Learning in the Energy Industry (EP&S)

Sagamore Hill 2

Chair: **Natalia Levina** (New York University)

New Technology Is Enabling the U.S. to Lower Our Energy Demands

Frederick Abernathy (Harvard University)

Organizational Adoption of Technology in a Regulated Market: The Case of Smart Grid

Jason Dedrick

Asymmetric Knowledge Acquisition: Evidence of Heterogeneities in Technological Learning in the U.S. Electricity Industry

Bruno Kamdem (The George Washington University)

Carmen Weigelt (Tulane University)

Ekundayo Shittu (The George Washington University)

Designing for the Commons: The Role of Digital Platforms in Driving Energy Efficiency Behaviors at a Community Level

Michael Kennedy (Washington State University)

John Correia (Washington State University)

K.D. Joshi (Washington State University)

Friday, May 26

AWARDS LUNCHEON

11:45 a.m.—1:30 p.m.

Atrium Ballroom

PANEL SESSION FIVE 1:30 p.m.—3:15 p.m.

5A Roundtable: Platform Governance and Regulation (G:M&PI)

Springwood Room

Chair: **Geoffrey Parker** (Dartmouth University)

Participants:

Alan Davidson (New America Foundation)

Michael Schrage (MIT)

Marshall Van Alstyne (Boston University)

5B Innovation, Science, and Governance (TM)

Executive Room

Chair: **David Broniatowski** (George Washington University)

Birth of prominent scientists

Claudia Gonzalez-Brambila (ITAM)

Markets for Technology and the Technological Trajectories of Entrepreneurial Startups

Mahka Moeen (University of North Carolina)

Seth Carnahan (University of Michigan)

Corporate Spin-offs and Innovation: Evidence from a Natural Experiment in the Korean Drama Industry

Yongwook (Yong) Paik (Washington University in St. Louis)

Yujin Kim (Shanghai Tech University)

Entrepreneurial Access to Market and Non-Market Resources: Chinese Venture Capital and High-Speed Rail

Winner, Conference Best Paper in the Innovation and Entrepreneurship Research Stream Award

Jiamin Zhang (Tsinghua University)

Andy Wu (Harvard Business School)

5C North America's Auto Industry: Trends in Geography and Possible Disruptions (GIS)

Montpelier Room

Chair: **Thomas Klier** (Federal Reserve Bank of Chicago)

Manufacturing Fuels Rural Pennsylvania

Eric Esoda (Northeastern Pennsylvania Industrial Resources)

Evidence of Persistence of the U.S. Automotive R&D Cluster

Thomas Klier (Federal Reserve Bank of Chicago)

Thomas Walstrum (Federal Reserve Bank of Chicago)

When Do States Disrupt Industries? Electric Cars in Germany and the United States

Jonas Nahm (Johns Hopkins University)

Jonas Meckling (University of California, Berkeley)



Friday, May 26

Mexico's Remarkable Growth in Vehicle Production: A Detailed Analysis of Production and Exports

James Rubenstein (Miami University)

Thomas Klier (Federal Reserve Bank of Chicago)

What Disruption?: Sharing, Electric Cars, Autonomous Cars

Mike Smitka (Washington and Lee University)

5D Antecedents and Barriers to Internal and External Mobility (LMO&ER)

Senate Room

Chair: **Andrew Weaver** (University of Illinois at Urbana-Champaign)

Unpacking Institutional and Individual Antecedents of Employees' Internal Mobility Preferences

John McCarthy (Cornell University)

Turbulence in the Interior Fit Out Industry in Singapore

Nitin Pangarkar (National University of Singapore)

Human and Social Capital for Predicting Early Career Success

Sumita Raghuram (Pennsylvania State University)

Ravi Gajendran (University of Illinois, Urbana Champaign)

Noncompetes and Employee Mobility

Evan Starr (University of Maryland)

5E The Integration of the US into the Global Economy (G:M&PI)

Ashlawn Room

Chair: **Frank Dubois** (American University)

How American are Cars Sold in the U.S. Market: A Longitudinal Study

Frank DuBois (Kogod School, American University)

The Road to Integration of the U.S. Economy in Global Production

Jiemin Guo (U.S. Department of Commerce)

Peter Kuhbach (U.S. Department of Commerce)

Erich Strassner (U.S. Department of Commerce)

Before the U.S. Tariff Commission: Congress' Efforts to Obtain Statistics and Analysis for Tariff-setting, 1789-1916

Andrew Reamer (George Washington University)

5F Roundtable: The Value Added 'Third-Side' Role of the Federal Government in Labor Dispute Resolution (LMO&ER)

Sagamore Hill 1

Chair: **Ariel Avgar** (Cornell University)

Participants:

Conrad Bowling (Federal Mediation and Conciliation Services)

Lu-Ann Glaser (Federal Mediation and Conciliation Services)

Javier Ramirez (Federal Mediation and Conciliation Services)

Friday, May 26

5G Renewable Energy in China and the U.S. (EP&S)

Sagamore Hill 2

Chair: **David Hart** (George Mason University)

The Effect of Mandated CSR Disclosure on the Pollution Levels of Publicly-traded Chinese Firms

Jeffrey Gramlich (Washington State University)

Li Huang (Washington State University)

Up, Down, and Sideways: Divergent Innovation Trajectories in China's Plug-in Electric Vehicle Industry

John Helveston (Boston University)

Valerie Karplus (MIT)

Yanmin Wang (Beijing Normal University)

Erica Fuchs (Carnegie-Mellon University)

Clean Energy Innovation Clusters and their Influence on Manufacturing

Derek Hill (National Science Foundation)

Jill Engel-Cox (National Renewable Energy Laboratory)

BREAK 3:15 p.m.—3:45 p.m.

PANEL SESSION SIX 3:45 p.m.—5:30 p.m.

6A Award Winners Panel (GIS)

Springwood Room

Chair: **Ann Frost** (Ivey Business School)

"Development and Adoption of Plug-in Electric Vehicles in China: Markets, Policy, and Innovation"

Winner, Dissertation Award

John Helveston (Boston University)

"Dismantling Knowledge Boundaries at NASA: From Problem Solvers to Solution Seekers"

Winner, Giarratani Rising Star Award

Hila Lifshitz-Assaf (New York University)

"Temporary De-Embedding Buyer-Supplier Relationships: A Complexity Perspective"

Runner-up, Giarratani Rising Star Award

Merieke Stevens (Erasmus University)

Co-authors: Fabian Sting (University of Cologne) and Murat Tarakci (Erasmus University)

6B Industrial Development and Innovation: The Importance of Context (GIS)

Executive Room

Chair: **Jennifer Woolley** (Santa Clara University)

Role of Public Policy in Supporting Accelerators

Daniel Basco (RAND Corporation)

Carlos Ignacio Gutierrez (RAND Corporation)

Marlon Graf (RAND Corporation)

Capital and Context: New Software Venture Support Organizations in Beirut

William Benton (College of William and Mary)



Friday, May 26

Information Through Third Party Affiliations: Influence of Venture Capital in M&A Market

Supradeep Dutta (State University of New York - Buffalo)

Evaluation of End-To-End Strategies with Omnichannel Retailing for Apparel Supply Chains

Shardul Phadnis (Malaysia Institute for Supply Chain Innovation)

The Rejection of Socially Conscious Institutions in the Bean-To-Bar Chocolate Market

Jennifer Woolley (Santa Clara University)

Jo-Ellen Pozner (Santa Clara University)

Michaela DeSoucey (North Carolina State University)

6C Coping with Discontinuities and Disruption (I&E)

Montpelier Room

Chair: **Callen Anthony** (Boston College)

How Revolutions Shape (or Rather Blur) Markets: Initial Insights from the Arab Spring

Daniel Armanios (Carnegie Mellon University)

Amr Adly (American University of Cairo)

Informal Certification: Resolving the Tension Between Lowering Barriers to Entry and Obtaining Legitimacy

Robert Eberhart (Santa Clara University)

Back to the Future: Innovation, Cultural Disruption and the Resurgence of Analog Synthesizers

Andrew Nelson (University of Oregon)

Callen Anthony (Boston College)

Mary Tripsas (Boston College)

Giving a Fish, Teaching Fish or Combing both Together: A Theoretical Study of Sustainable Poverty Reduction in China

Weichu Wu (East Stroudsburg University)

Daisy Wang (East Stroudsburg University)

6D Labor Markets, Careers, and Entrepreneurship (LMO&ER)

Senate Room

Chair: **David Waguespack** (University of Maryland)

Still the Same: New Venture Job Creation and Workforce Segregation.

Jing Chen (Copenhagen Business School)

Christopher I. Rider (Georgetown University)

Relationship Asymmetry and Potential of Newness: The Spatial and Organizational Dynamics of Entrepreneurship in the Distribution Side of the Beer Industry

Tunde Cserpes (University of Illinois at Chicago)

Penny for Your Thoughts? The Effects of Patenting on Employee Inventor Careers

Justin Frake (University of Maryland)

Perception and Adoption of Occupational Licensure by Entrepreneurs: The Case of Tax Preparers in the U.S.

Roman V. Galperin (Johns Hopkins University)

Kyle Albert (Harvard University)

Aleksandra Kacperczyk (Massachusetts Institute of Technology)

Friday, May 26

6E How Politics, Institutions and Social Change Shape Strategy (G:M&PI)

Ashlawn Room

Chair: **Robert Weiner** (George Washington University)

The Impact of the 2008-2013 Great Recession in the Different Industries of the Spanish Economy

Miguel A. Arino (IESE Business School)

Political Shock and Firm Performance: Evidence from Telecommunications License Cancellations in India

Daniel Blake (IE Business School)

Srividya Jandhyala (Princeton/ ESSEC Business School)

Indian IT: State-Dominated Development, Entrepreneurship, or Multinational Value-Chain?

Pamela Meil (Institute for Social Science Research, Munich)

Hal Salzman (Rutgers University)

Barbarians at the Gate: How Foreign Competition Influences Intra-Organizational Strategic Conflict

Romel Mostafa (Ivey Business School)

Do Foreign Multinationals Gain from Transparency Regulation? Evidence from Canadian Oil

Jieun Shin (George Washington University)

Robert Weiner (George Washington University)

6F Technology-Enabled Supply Chains (SNO&EM)

Sagamore Hill 1

Chair: **Tomas Harrington** (University of Cambridge)

The Start-Up Space Supply Chain

Travis Doom (The Tauri Group)

Anton Dolgoplov (The Tauri Group)

Phil Smith (The Tauri Group)

Digital Transformation of Clinical Trials, Manufacturing and Supply Chains: Evidence from the Pharmaceutical Industry

Tomas Harrington (University of Cambridge)

Nitin Joglekar (Boston University)

Jagjit Singh Srai (University of Cambridge)

Artificial Intelligence as a Potential Tool for Production Planning - Case from the Automotive Industry

Peter Nemeth

Thomas Bernhard Ladinig

Lightweight, Heavy Lifting: Knowledge Flows and Technology Transfer in a Materials Technology Lab

Peter Warrian (University of Toronto)

6G Public Policies in U.S. Electricity and Transportation Sectors (EP&S)

Sagamore Hill 2

Chair: **Ekundayo Shittu** (The George Washington University)

Valuing the Impact of Storage in Nuclear Hybrid Energy Systems

Ted Baker (The George Washington University)

Ekundayo Shittu (The George Washington University)



Friday, May 26

When Agents Trade in Electricity Attributes, Who Benefits?

Janiele Custodio (George Washington University)

Ekundayo Shittu (George Washington University)

Effect of Demand, Capacity Factor, and Environmental Policy Uncertainties on Generation Capacity Expansion Investments

Iika Deluque (The George Washington University)

Compliance by Design: Influence of Acceleration Tradeoffs on CO2 Emissions and Costs of Fuel Economy and Greenhouse Gas Regulations

Kate Whitefoot (Carnegie Mellon University)

Meredith Fowlie (University of California, Berkeley)

Steven Skerlos (University of Michigan)

Sessions conclude at 5:30 p.m.

Please give us your feedback!

<https://tinyurl.com/isa2017survey>

Thank you!